

Case Study_CS16_HouseCentón_Spain

FSPW Floor slab party wall. Vertical section.

EXISTING

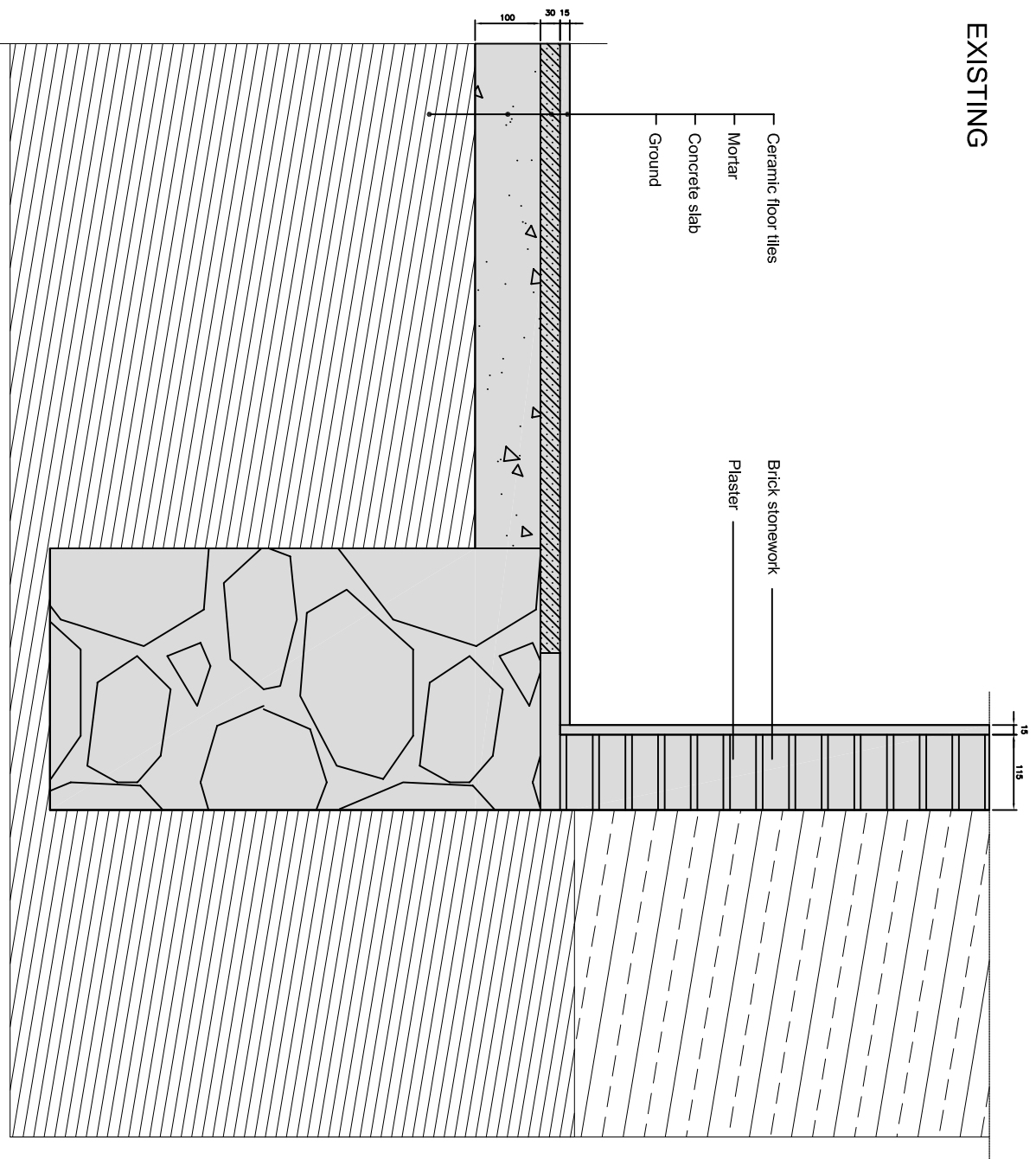

| | |
|--------|----------------------|
| Scale | 1:10 @ A4 |
| Author | Nuria Diaz/Anne Vogt |
| Date | 28.04.2015 |



COLOR CODE

- Existing building
- Step 1
- Step 2
- Step 3
- Step 4

temporary works
(in between steps)

Airtight layer

DESCRIPTION/CHALLENGES

Case Study_CS16_HouseCentón_Spain

FSPW | Floor slab party wall. Vertical section. - THERM

Existing

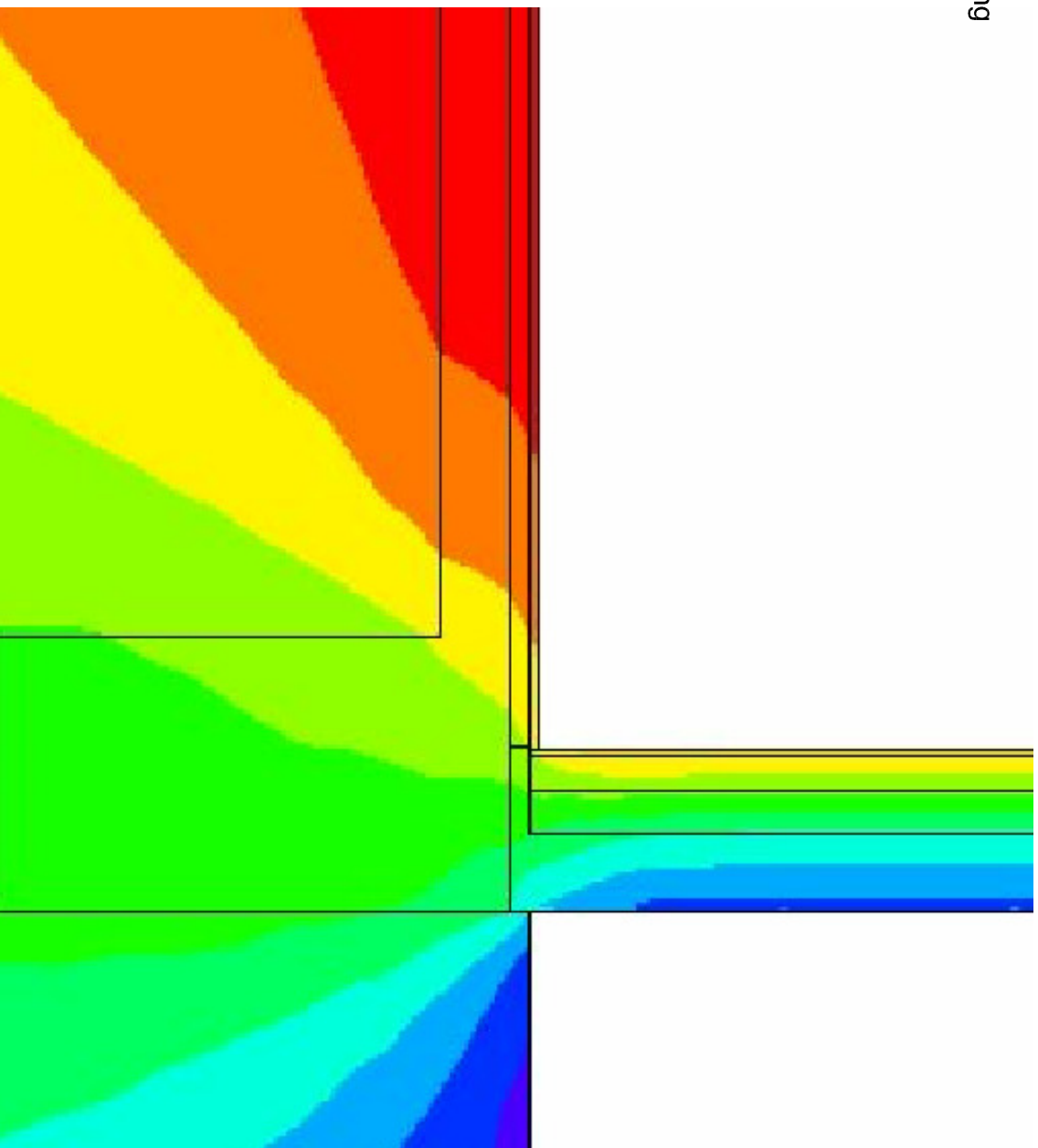

ψ - value [W/mK] = 0.035

| | |
|--------|----------------------|
| Scale | 1:10 @ A4 |
| Author | Nuria Diaz/Anne Vogt |
| Date | 30.09.2016 |



COLOR CODE

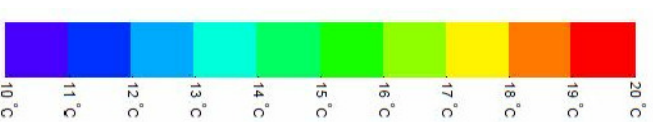

Co-funded by the Intelligent Energy Europe Programme of the European Union

The sole responsibility for the content of this publication lies with the authors. It does not necessarily reflect the opinion of the European Union. Neither the EACI nor the European Commission are responsible for any use that may be made of the information contained therein.

EuroPHIT

Case Study_CS16_HouseCentón_Spain



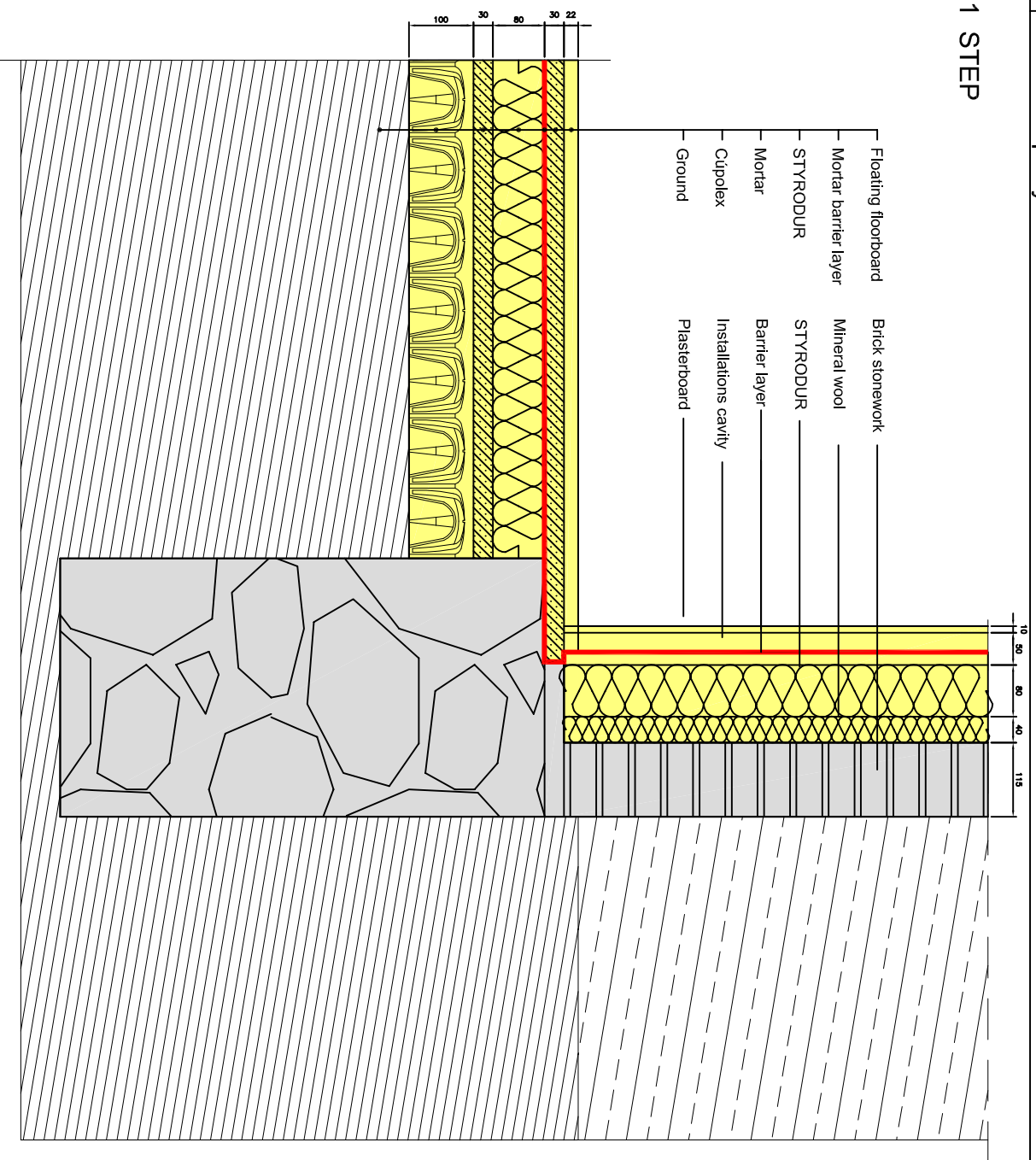

FSPW Floor slab party wall. Vertical section.

1 STEP

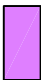

| | | |
|--------|----------------------|---|
| Scale | 1:10 @ A4 |  |
| Author | Nuria Diaz/Anne Vogt | |
| Date | 28.04.2015 | |

COLOR CODE

-  Existing building
-  Step 1
-  Step 2
-  Step 3
-  Step 4

 temporary works
(in between steps)

 Airtight layer

DESCRIPTION/CHALLENGES

Case Study_CS16_HouseCentón_Spain

FSPW | Floor slab party wall. Vertical section. - THERM

| | | |
|--------|----------------------|---|
| Scale | 1:10 @ A4 |  PLATAFORMA EDIFICACION PASSTIVHAUS |
| Author | Nuria Diaz/Anne Vogt | |
| Date | 30.09.2016 | |

Step 1

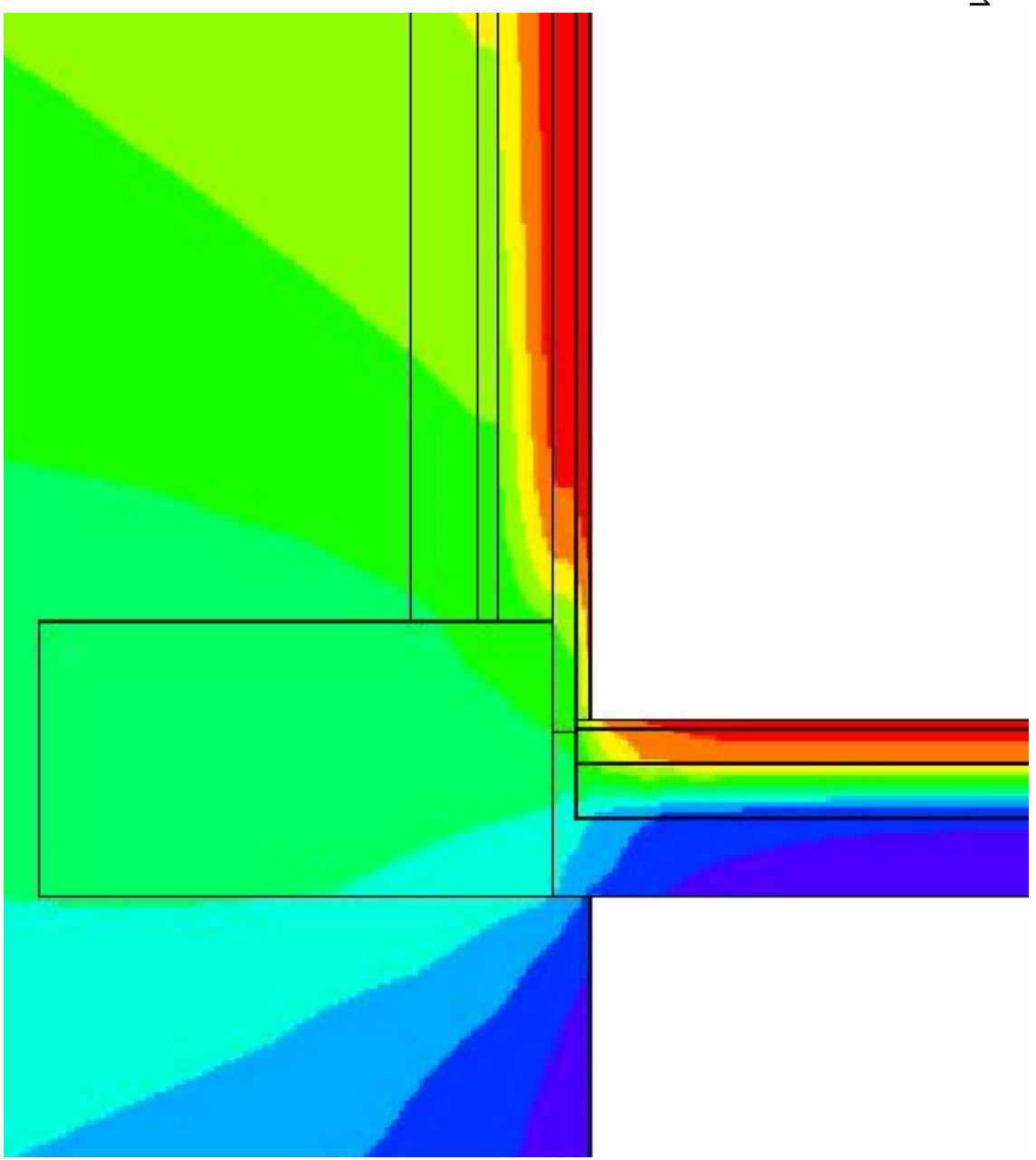

ψ - value [W/mK] = -0.165

COLOR CODE

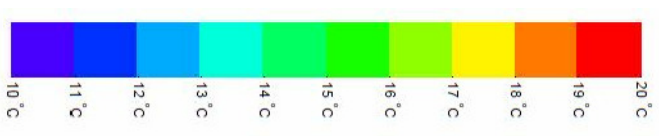

Co-funded by the Intelligent Energy Europe Programme of the European Union

The sole responsibility for the content of this publication lies with the authors. It does not necessarily reflect the opinion of the European Union. Neither the EACI nor the European Commission are responsible for any use that may be made of the information contained therein.

