

STEP 1

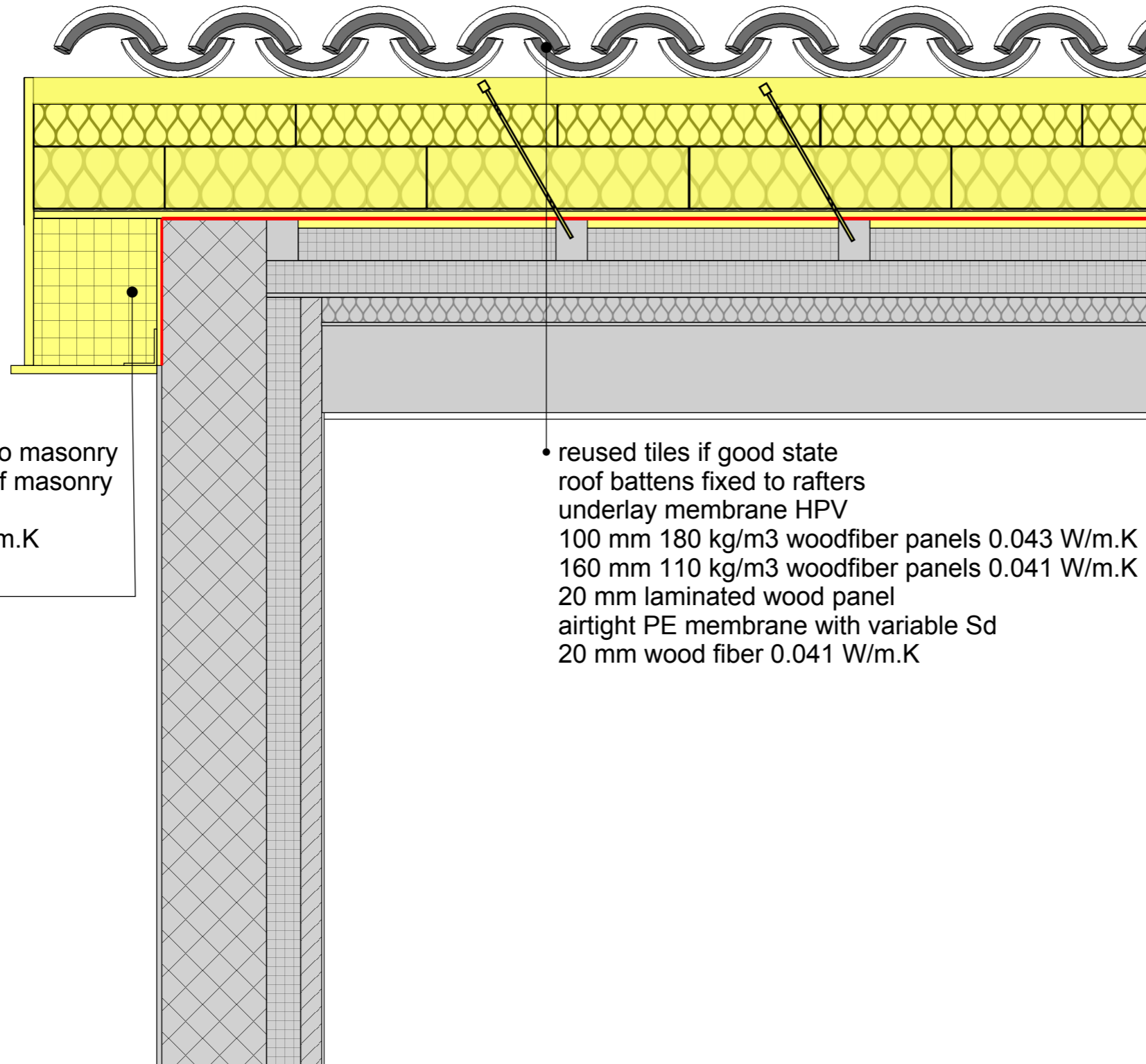

airtight PE membrane glued to masonry
new mortar on exterior face of masonry
as airtight layer
EPS block 200 mm 0.032 W/m.K
15 mm plywood

- reused tiles if good state
- roof battens fixed to rafters
- underlay membrane HPV
- 100 mm 180 kg/m³ woodfiber panels 0.043 W/m.K
- 160 mm 110 kg/m³ woodfiber panels 0.041 W/m.K
- 20 mm laminated wood panel
- airtight PE membrane with variable Sd
- 20 mm wood fiber 0.041 W/m.K

COLOR CODE

- Existing building
- Step 1
- Step 2
- Step 3
- Step 4
- temporary works (in between steps)

Airtight layer

DESCRIPTION/CHALLENGES

High air leakage at plank ceiling

NOTES