

STEP 1

airtight PE membrane glued to masonry  
new mortar on exterior face of masonry  
as airtight layer behind zinc edge strip

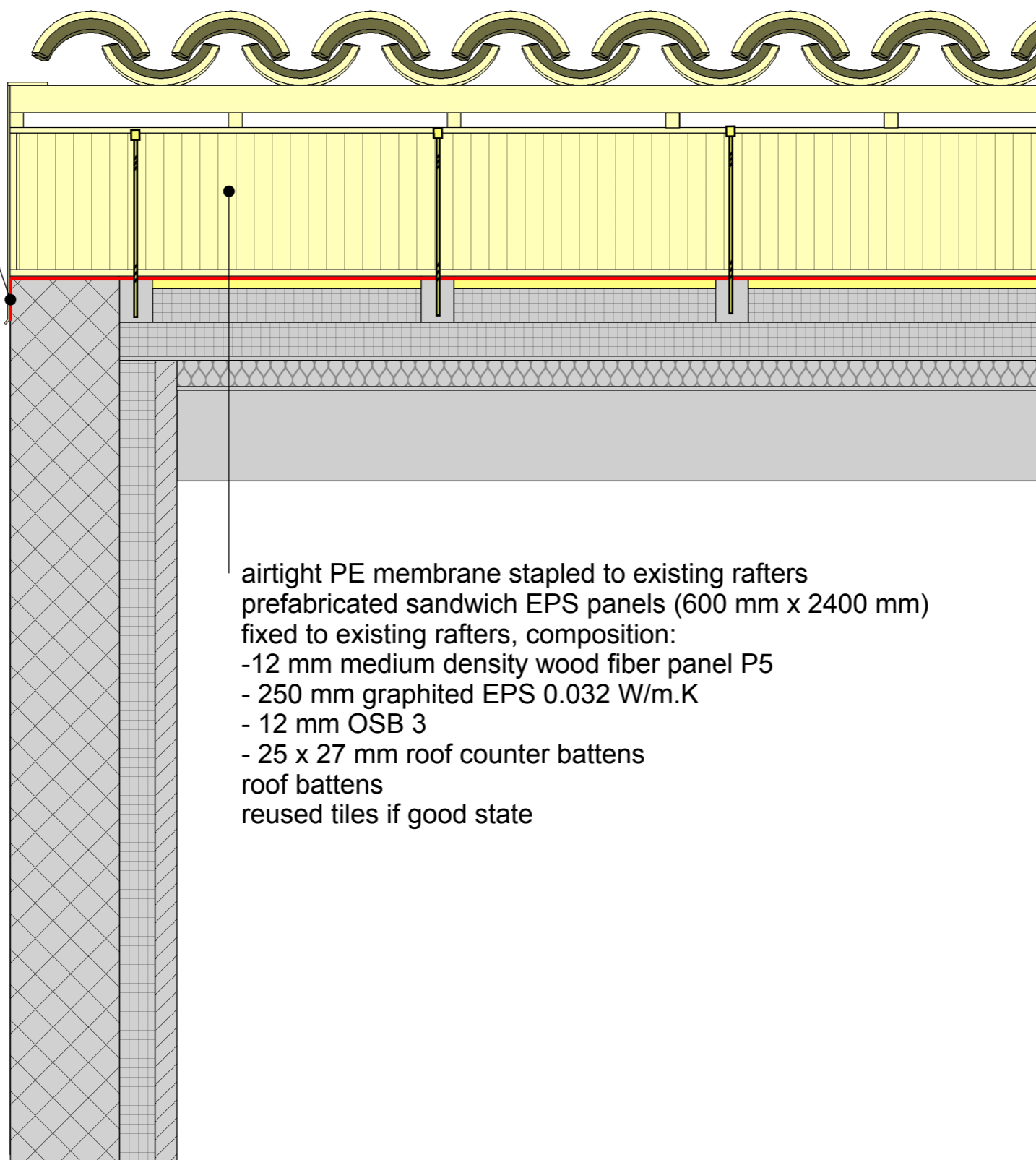

airtight PE membrane stapled to existing rafters  
prefabricated sandwich EPS panels (600 mm x 2400 mm)  
fixed to existing rafters, composition:  
- 12 mm medium density wood fiber panel P5  
- 250 mm graphited EPS 0.032 W/m.K  
- 12 mm OSB 3  
- 25 x 27 mm roof counter battens  
roof battens  
reused tiles if good state

COLOR CODE

- Existing building
- Step 1
- Step 2
- Step 3
- Step 4
- temporary works  
(in between steps)

Airtight layer

DESCRIPTION/CHALLENGES

Anticipate the continuity of airtight layer  
as outer face of exterior wall is the  
airtight layer.

Roof airtight membrane between  
insulation layers : check that it is not  
placed further than 33% of total roof  
thermal resistance.

NOTES