

STEP 2

200 mm EPS 0.032 W/m.K
+ OSB 3 12 mm
additional roof structure fixed to
battens at gable
replaced zinc edge strip

200 mm EPS 0.032 W/m.K
+ 8 mm mineral render

5 mm mortar glue on exterior
face of masonry as airtight layer

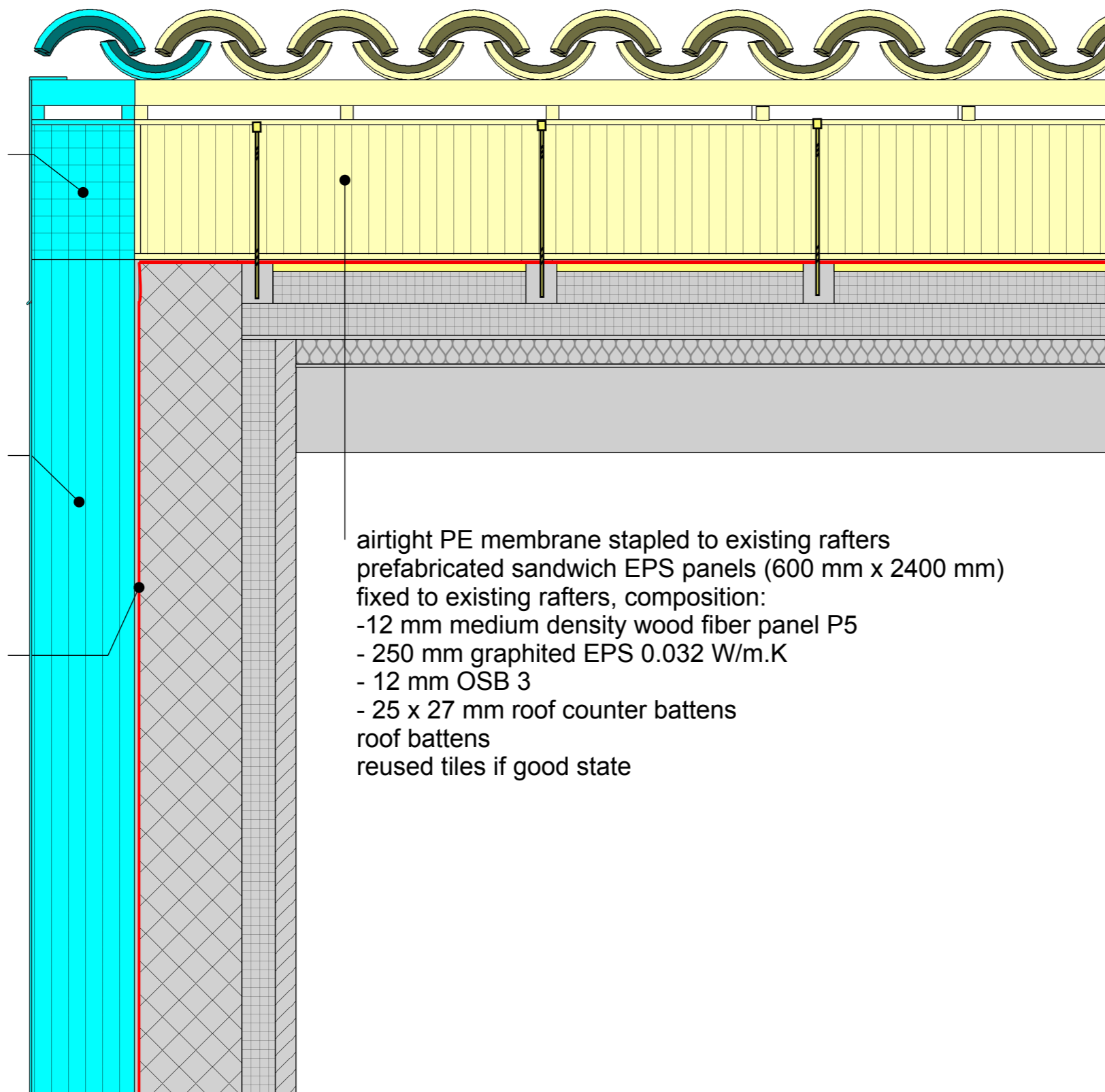

airtight PE membrane stapled to existing rafters
prefabricated sandwich EPS panels (600 mm x 2400 mm)
fixed to existing rafters, composition:
- 12 mm medium density wood fiber panel P5
- 250 mm graphited EPS 0.032 W/m.K
- 12 mm OSB 3
- 25 x 27 mm roof counter battens
roof battens
reused tiles if good state

COLOR CODE

- Existing building
- Step 1
- Step 2
- Step 3
- Step 4
- temporary works
(in between steps)

Airtight layer

DESCRIPTION/CHALLENGES

Anticipate the continuity of airtight layer as outer face of exterior wall is the airtight layer.

Roof airtight membrane between insulation layers : check that it is not placed further than 33% of total roof thermal resistance.

NOTES