

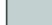





COLOR CODE

-  Existing building
-  Step 1
-  Step 2
-  Step 3
-  Step 4
-  temporary works
(in between steps)

Airtight layer

DESCRIPTION/CHALLENGES

The existing insulation is conserved if not damaged. Flexible ducts from the new ventilation unit placed in the attic distribute supply air to living rooms and bedrooms. Then mineral fiber is blown with a thickness of 300 mm. A new batten extends the eave to get a continuous insulation layer with the 300 mm EPS wall insulation layer.

Challenges for first step:

- Careful installation of the airtight membrane
- Follow optimized ducting layout

Challenges for second step:

- Apply continuously primer and plaster spray on eave

NOTES

Works with tenants in situ

EXISTING

Final Step

COLOR CODE

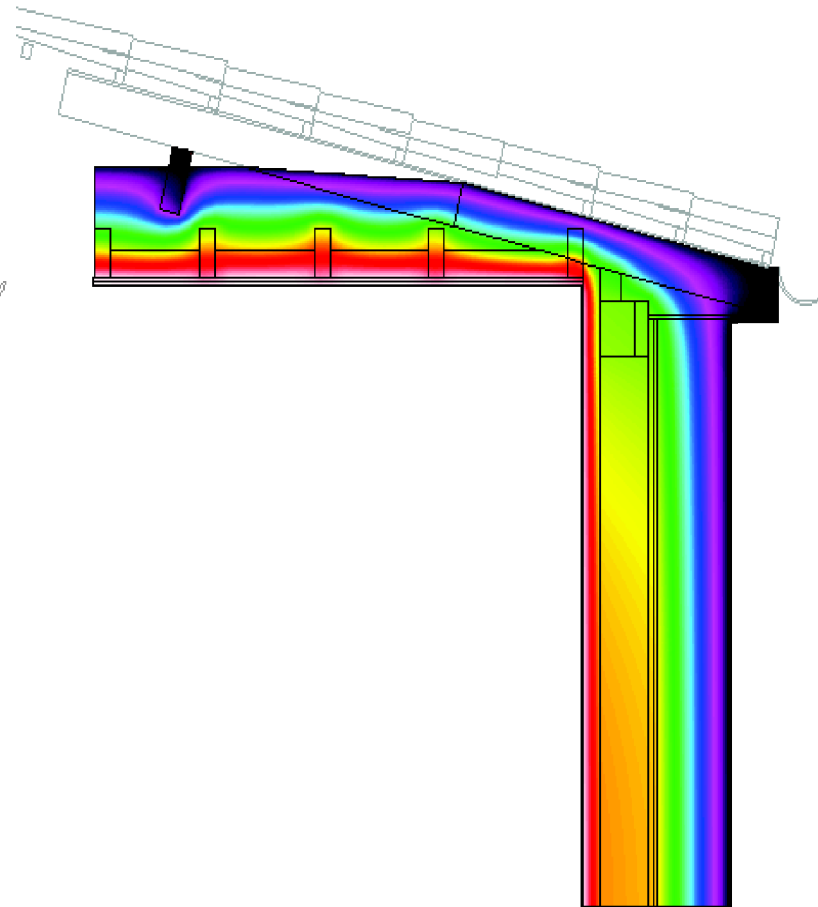
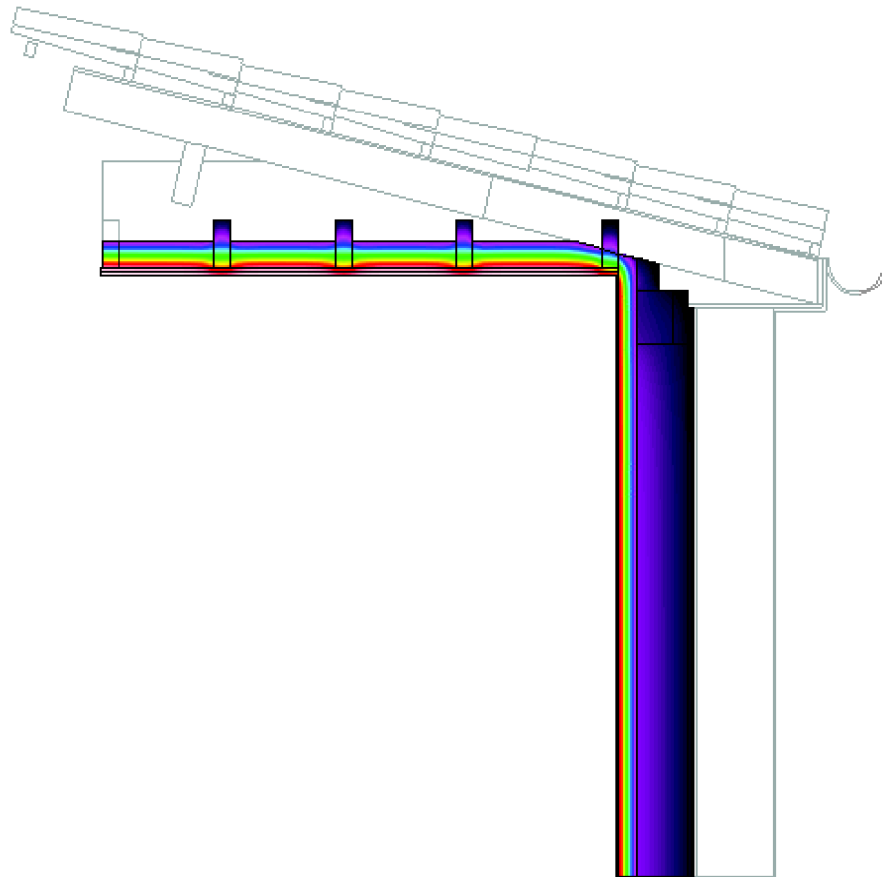
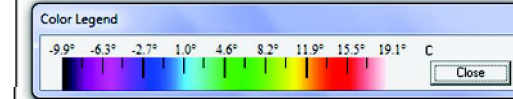

Ψ - value [W/mK] = 0.17

Ψ - value [W/mK] = 0.06

DESCRIPTION/CHALLENGES

